

PART NUMBER: AL1731-DEU-1031-A010SR11-11G12

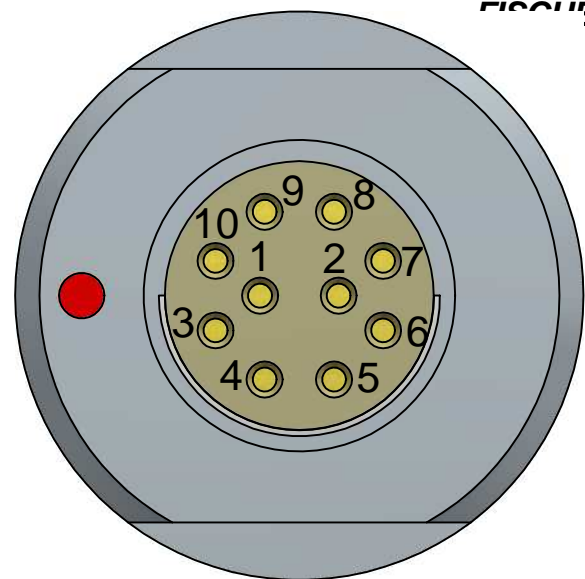

VIEWED FROM MATING FACE

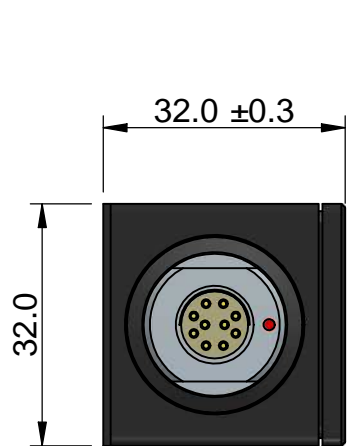

CONNECTOR ANGULAR POSITION WILL VARY

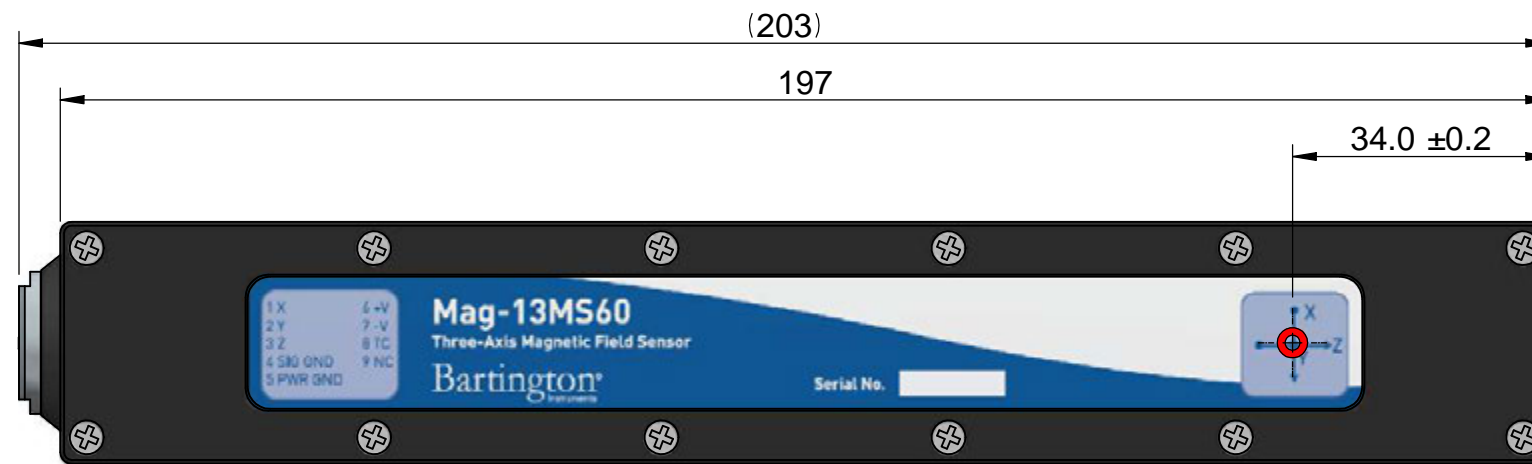

LABEL DETERMINED BY PRODUCT TYPE

MOUNTING POINTS FOR BARTINGTON USE ONLY

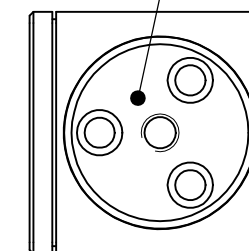

● - CENTER OF SENSING ELEMENTS

PIN No.	FUNCTION
1	X+
2	Y+
3	Z+
4	SGND
5	PGND
6	V+
7	V-
8	TEST
9*	ISP-TX
10	N.C.

* USED ONLY DURING PROGRAMING. PINS 9 & 10 NOT CONNECTED IN NORMAL OPERATION.



2 MOUNTING HOLES TAPPED M5 7mm MAX THREAD DEPTH

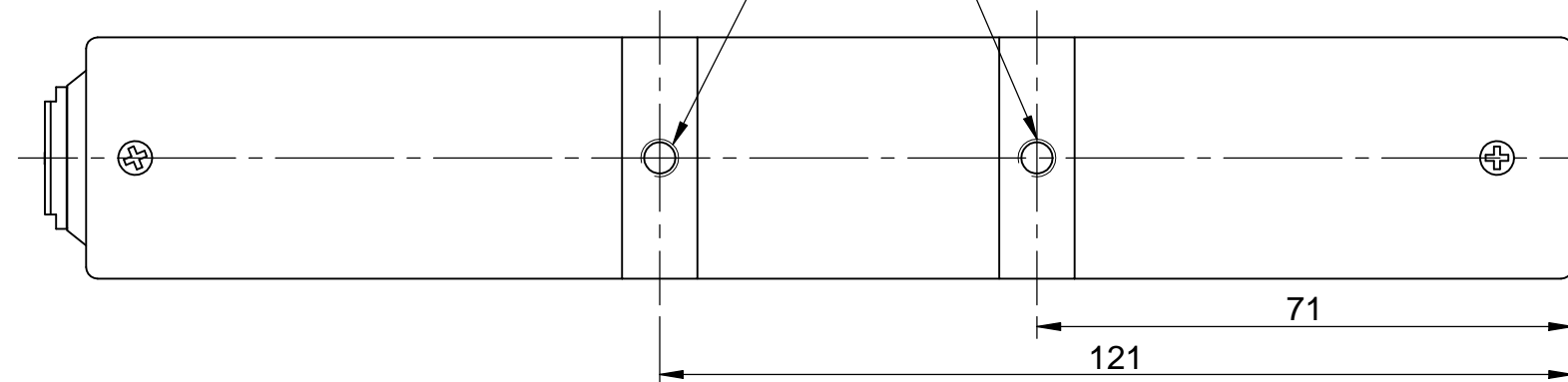

AXIS ORIENTATION



THIS DRAWING AND THE INFORMATION THEREIN IS CONFIDENTIAL AND MUST BE KEPT CONFIDENTIAL AND NOT REPRODUCED, COPIED OR USED FOR ANY PURPOSE WITHOUT THE PRIOR WRITTEN PERMISSION OF BARTINGTON INSTRUMENTS LTD.

DIMENSIONS ARE IN MILLIMETERS REMOVE ALL SHARP EDGES & BURRS

THIRD ANGLE PROJECTION

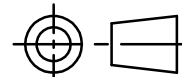

TOLERANCES FOR MACHINING: (UNLESS OTHERWISE SPECIFIED)

LINEAR:	ANGULAR:
XX ±0.3mm	XX ±0.5°
XX.X ±0.1mm	XX.X ±0°30'
XX.XX ±0.05mm	XX.XX ±0°00'30"

TITLE

Mag-13MS Outline Drawing

MATERIAL

SURFACE TEXTURE μm

MATERIAL FINISH

USED ON

PROJECT No D1309

DRAWN	M. Khaled	31/10/2013
MODIFIED	D. Cetnik	19/05/2014
CHECKED	M. Khaled	20/05/2014

SAGE/PART No

NA

DRAWING No DR3359

ISSUE 6

SEE DCN NUMBER FOR DESIGN CHANGE HISTORY